

SEZIONI E PACCHETTI

09

- PROGETTAZIONE ARCHITETONICA**
 Arch. Alessandro Bucci
 Cooproggetto
 architettonico ingegneria servizi
 via Severoli n.18 - 48018 Faenza (RA)
 Tel +39 0546 29237 Fax +39 0546 29261
 segreteria@cooproggetto.it
- PROGETTAZIONE RETE IDRICA/GAS E ILL. PUBBLICA**
 Per. Ind. Cristian Fabbi
 Per. Ind. Giuliano Rambelli
 Studio Associato Energia
 viale Marconi n.30/3 - 48018 Faenza (RA)
 Tel +39 0546 668163 Fax +39 0546 686301
 energia@studioenergia.it
- PROGETTAZIONE RETI FOGNARIE E LAMINAZIONE**
 Ing. Paolo Ruggieri
- PROGETTAZIONE ACUSTICA E AMBIENTALE**
 Ing. Franca Confi
- PROGETTAZIONE GEOLOGICA**
 Dott. Geol. Marabini Stefano

Profilo e committente
 Gea srl
 via del Rio n.400
 47522 Cesena (FC)

Firma dei tecnici ognuno per le proprie competenze

PLANIMETRIA PROGETTO
 scala 1:1.000

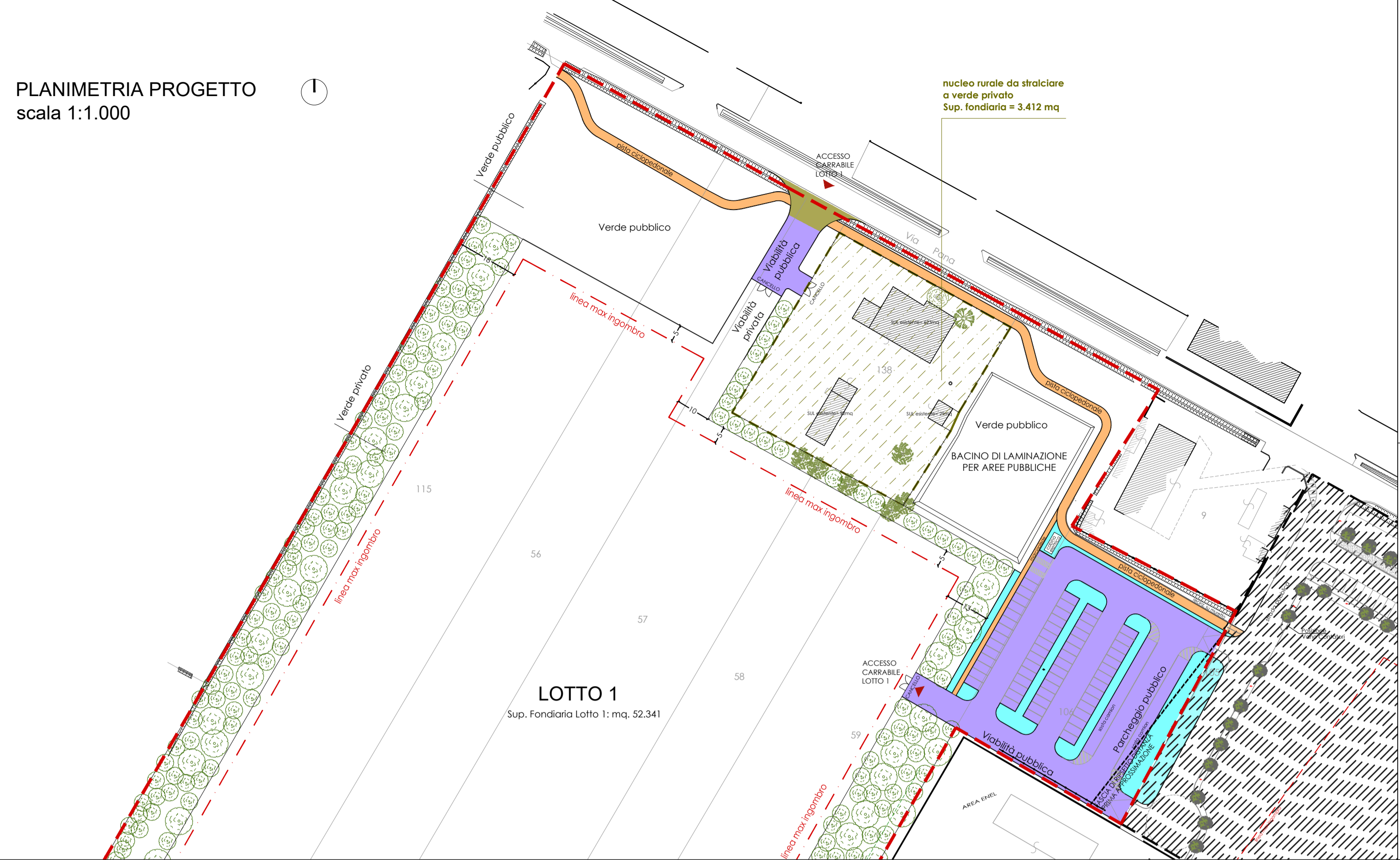

P1 - Pacchetto parcheggio e viabilità in asfalto
 scala 1:20

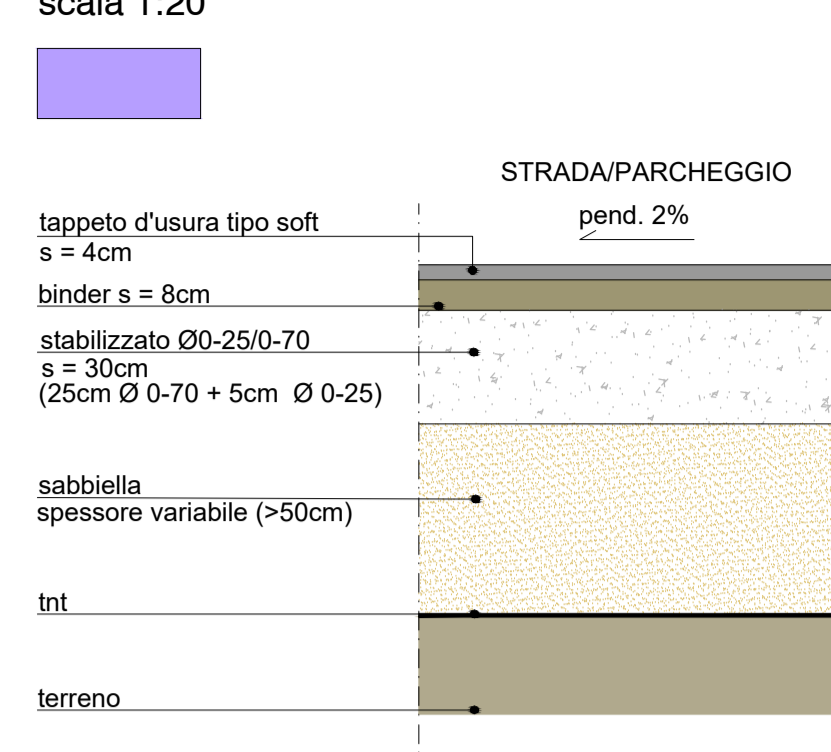

P2 - Pacchetto aiuola
 scala 1:20

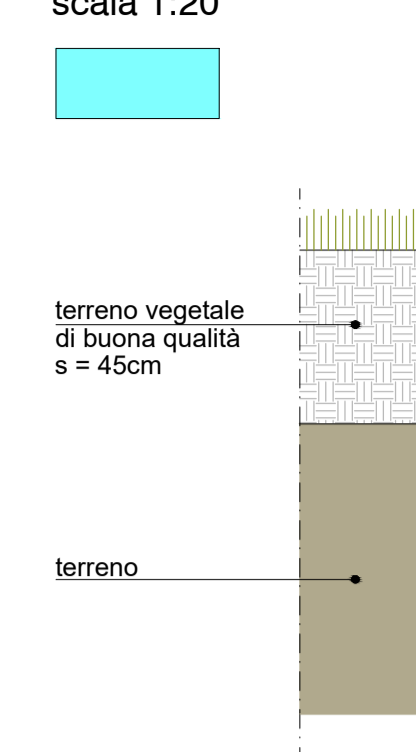

P3 - Pacchetto pista ciclopedonale e marciapiede
 scala 1:20

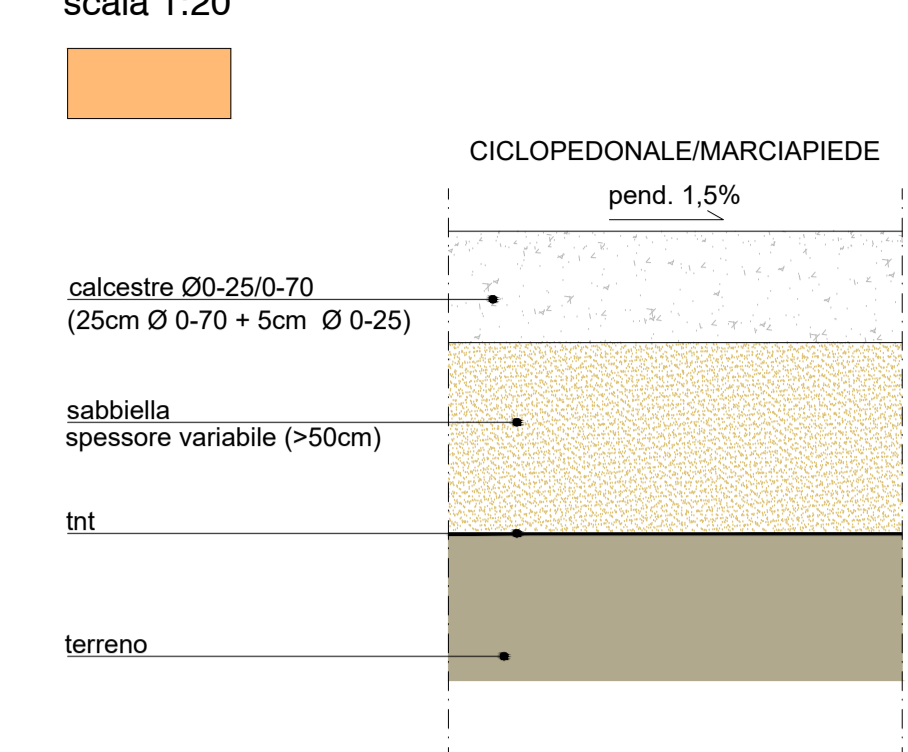

P4 - Pacchetto accesso lotto privato da via Pana
 scala 1:20

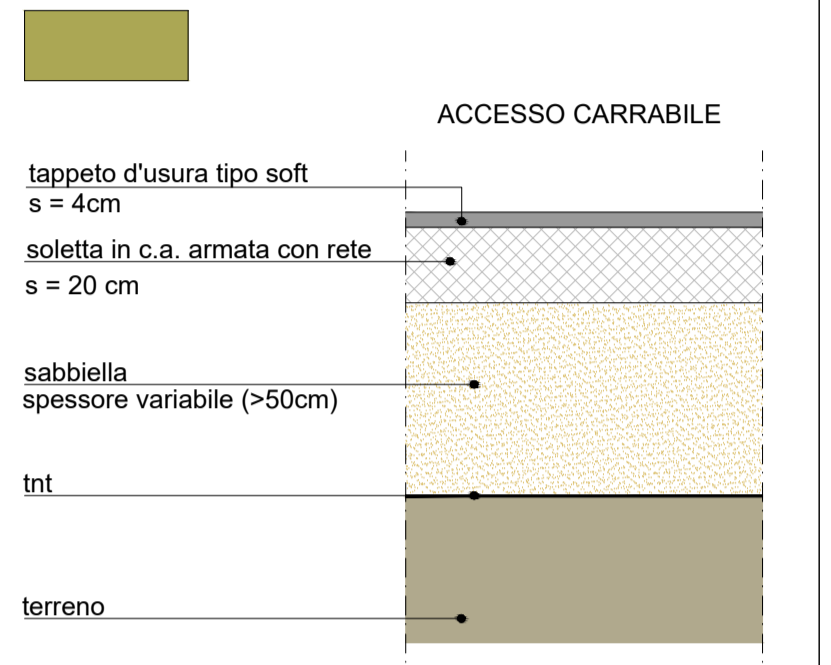

N1 - Nodo parcheggio - aiuola - scala 1:20

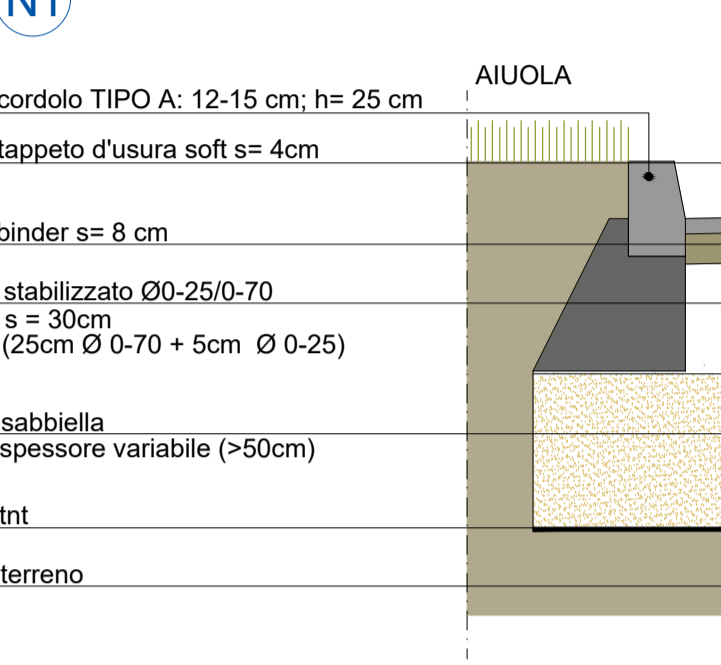

N2 - Nodo ciclopedonale - aiuola - scala 1:20

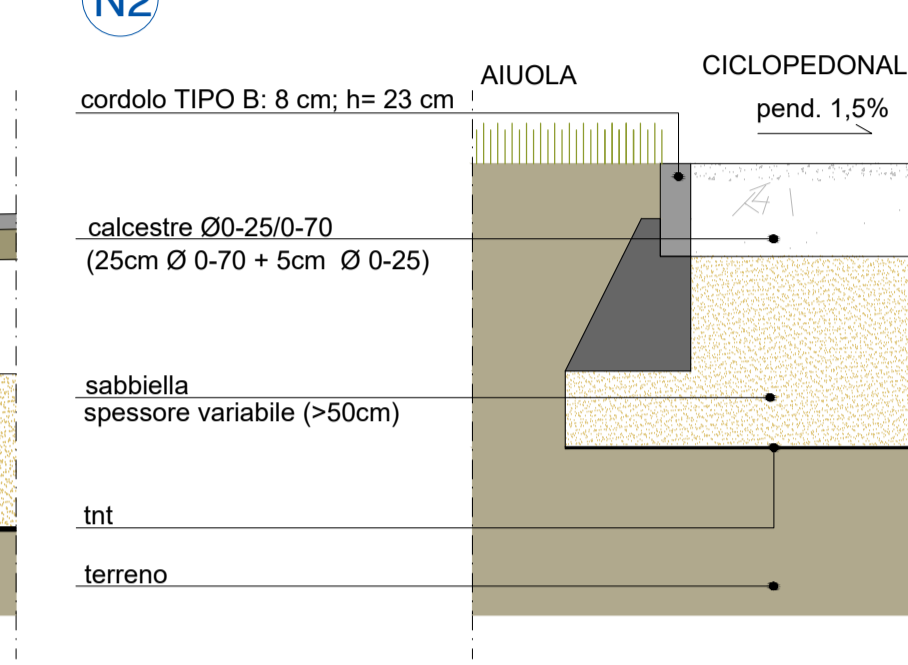

AREA DI INTERVENTO

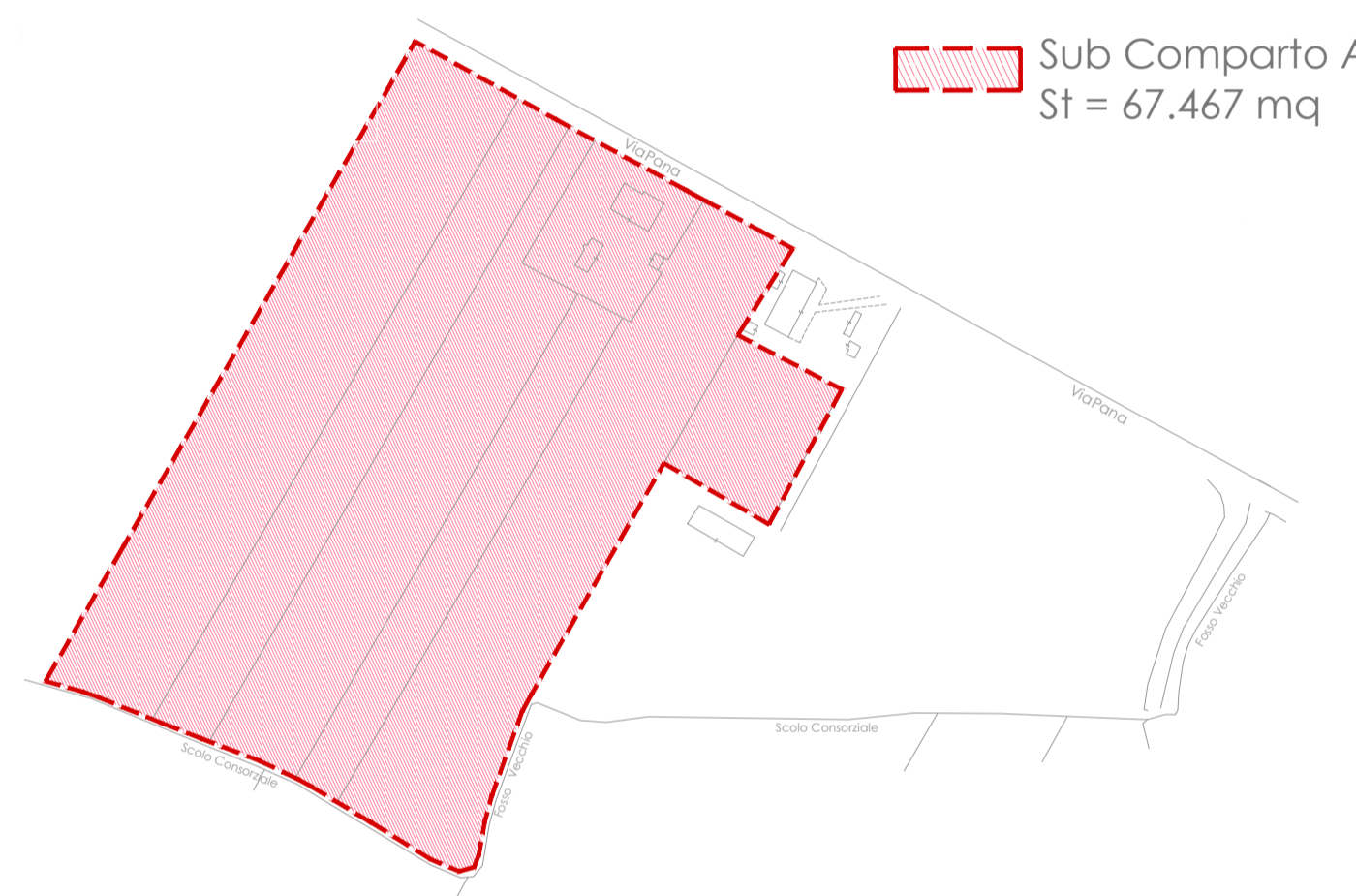

PLANIMETRIA PISTA CICLABILE-CONFINE
 scala 1:500

PLANIMETRIA ACCESSO DA VIA PANA
 scala 1:500

PLANIMETRIA INTERSEZIONE SNAM/FOGNATURA
 scala 1:500

PLANIMETRIA PARCHEGGIO PUBBLICO
 scala 1:500

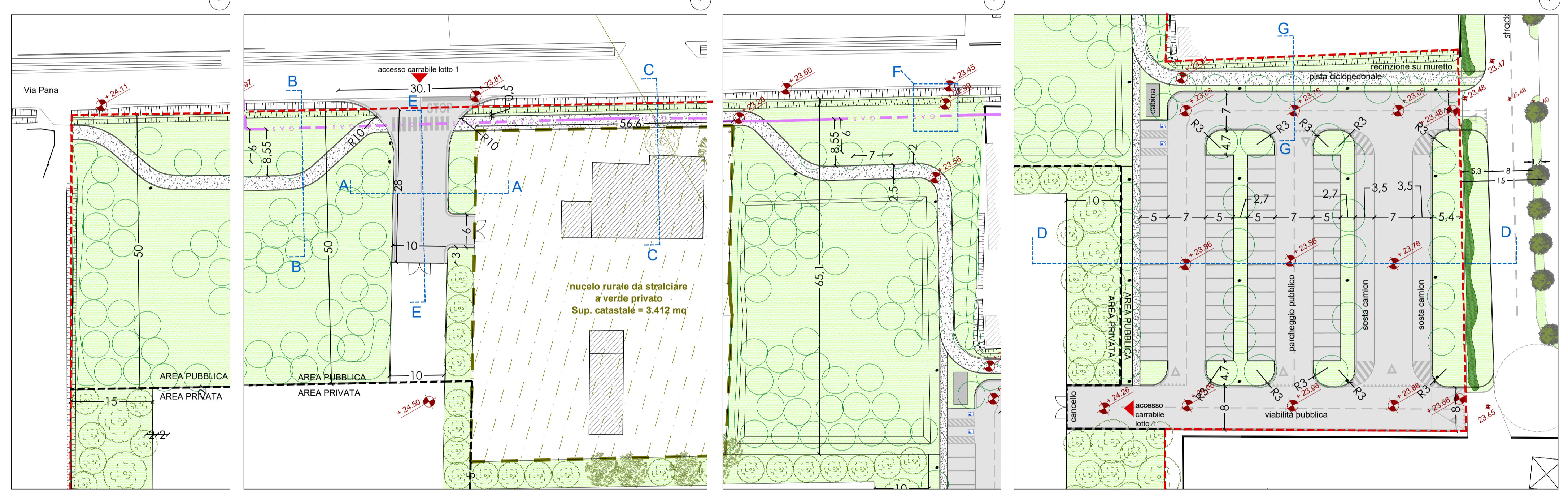

--- Superficie territoriale SUB COMPARTO A
 - - - Limite aree pubbliche/private

Dettaglio cordolo in c.a. TIPO A - scala 1:10

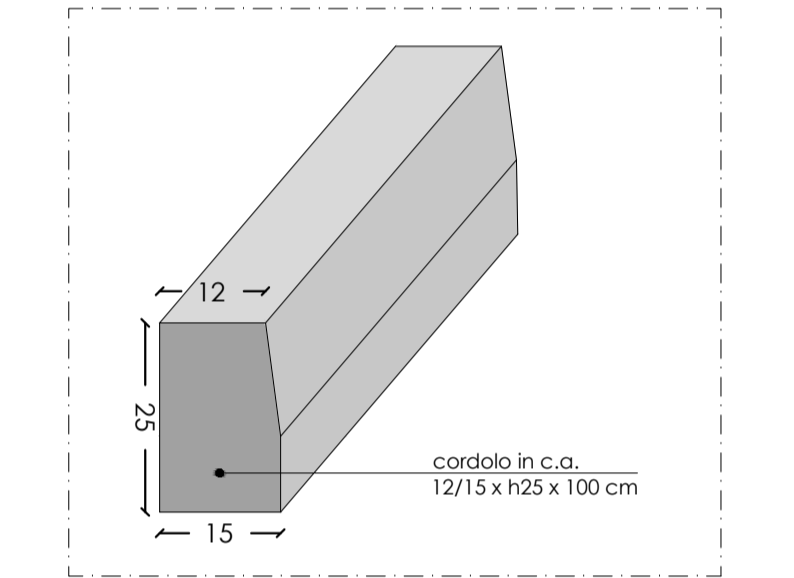

Dettaglio cordolo in c.a. TIPO B - scala 1:10

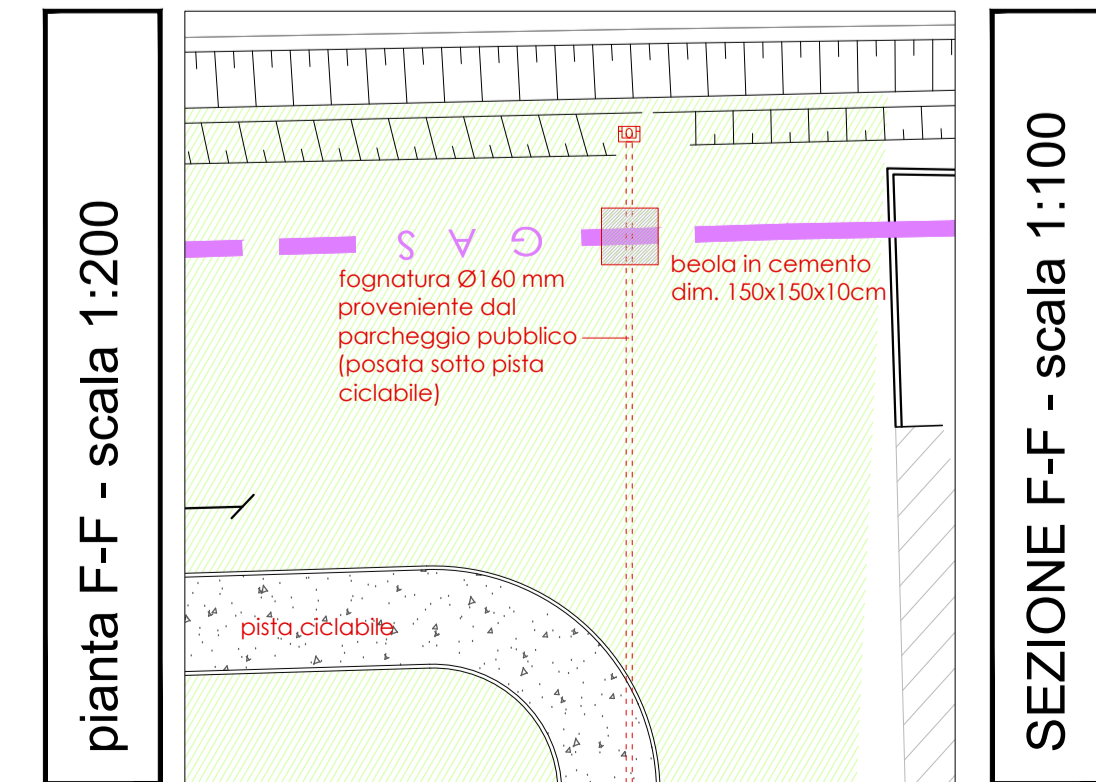
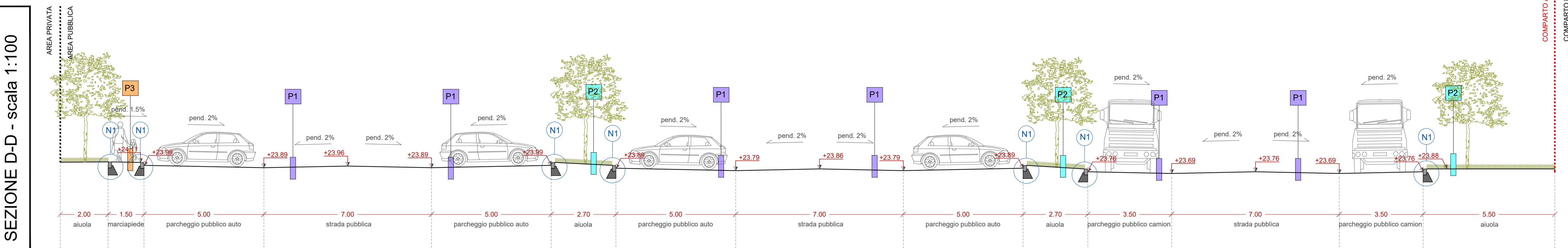
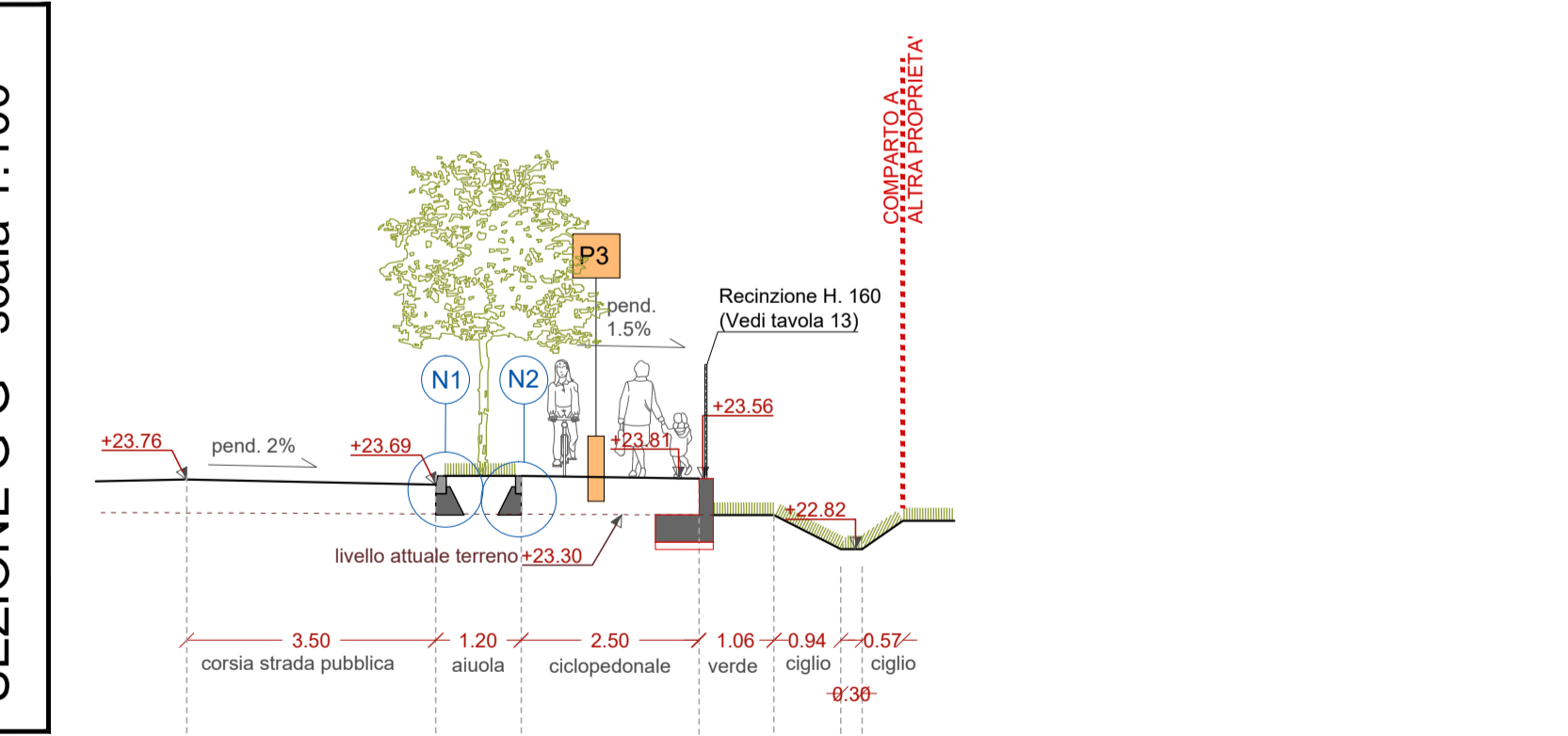
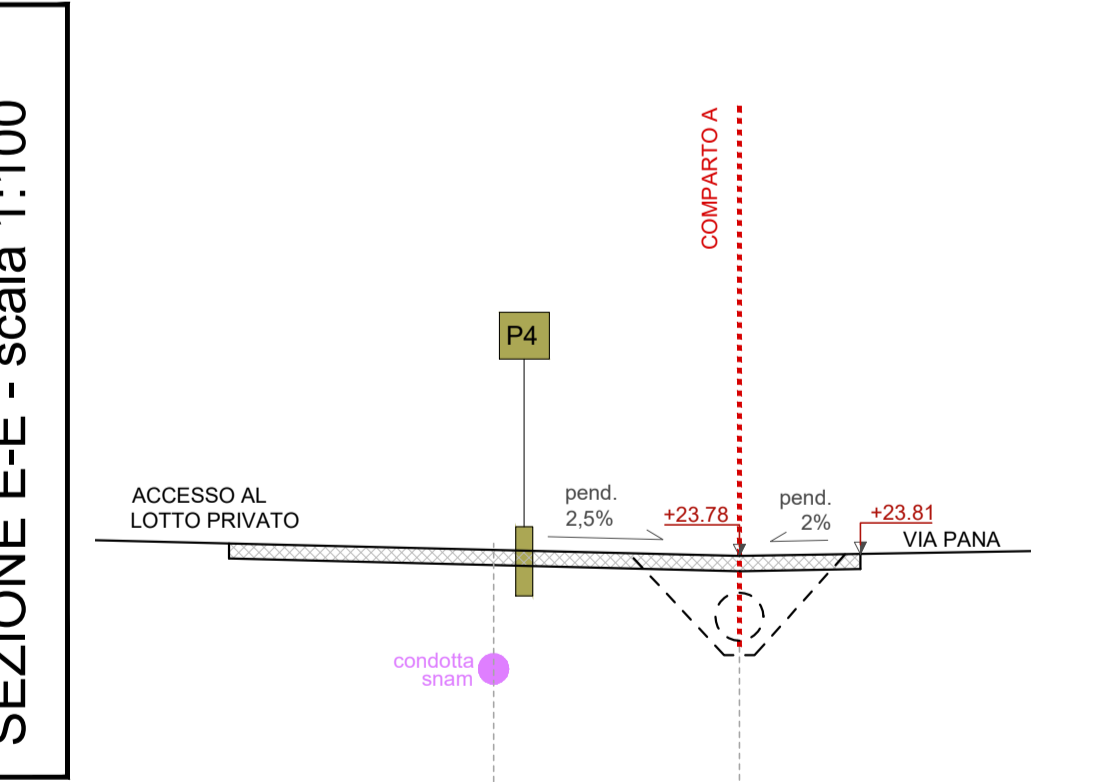
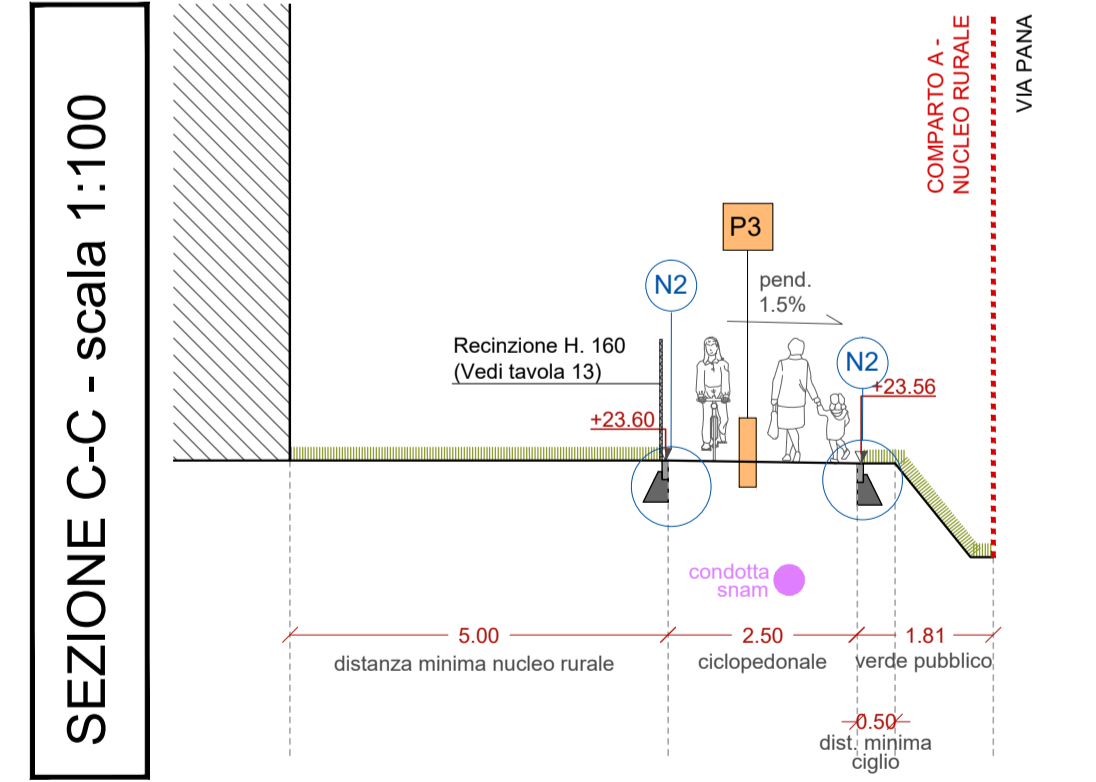
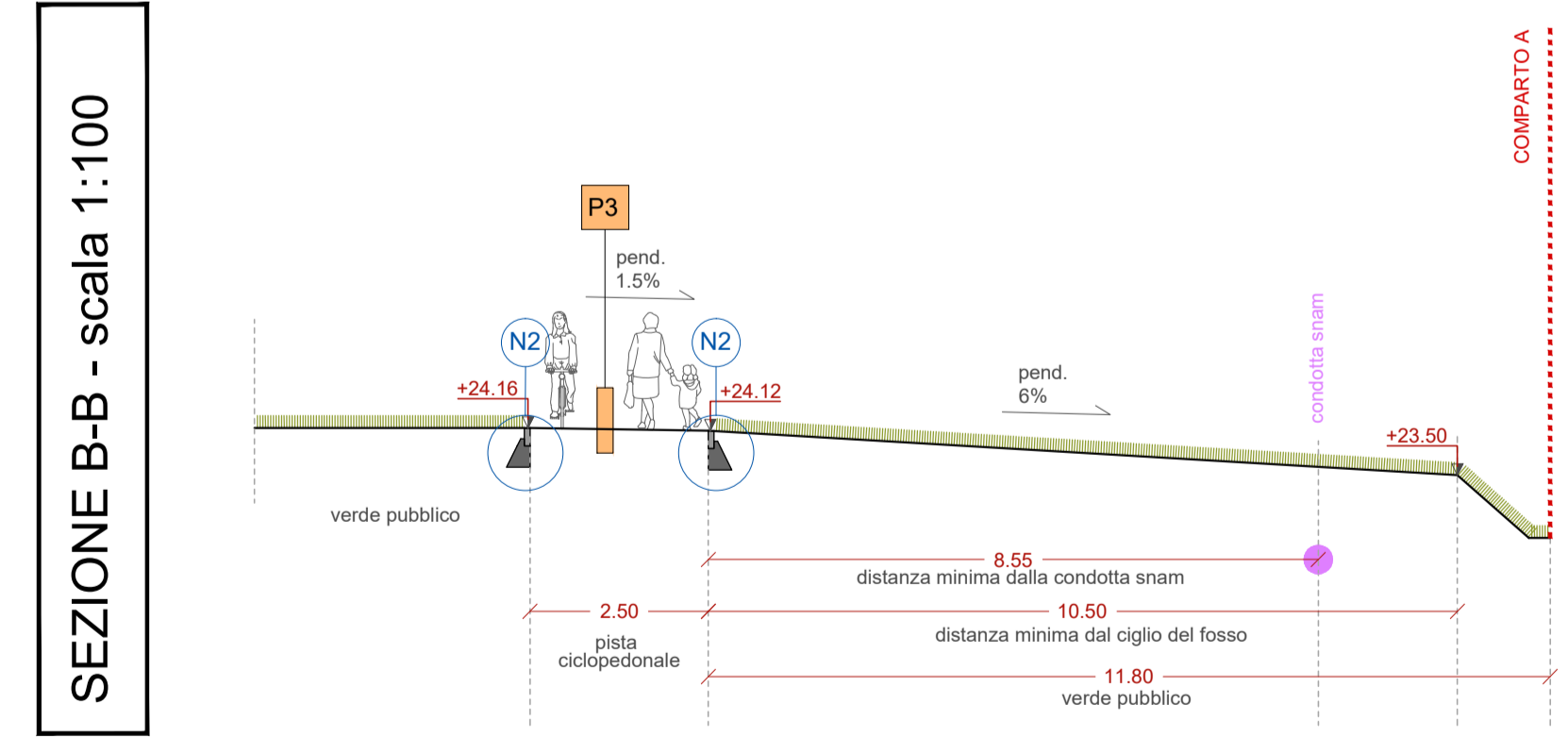
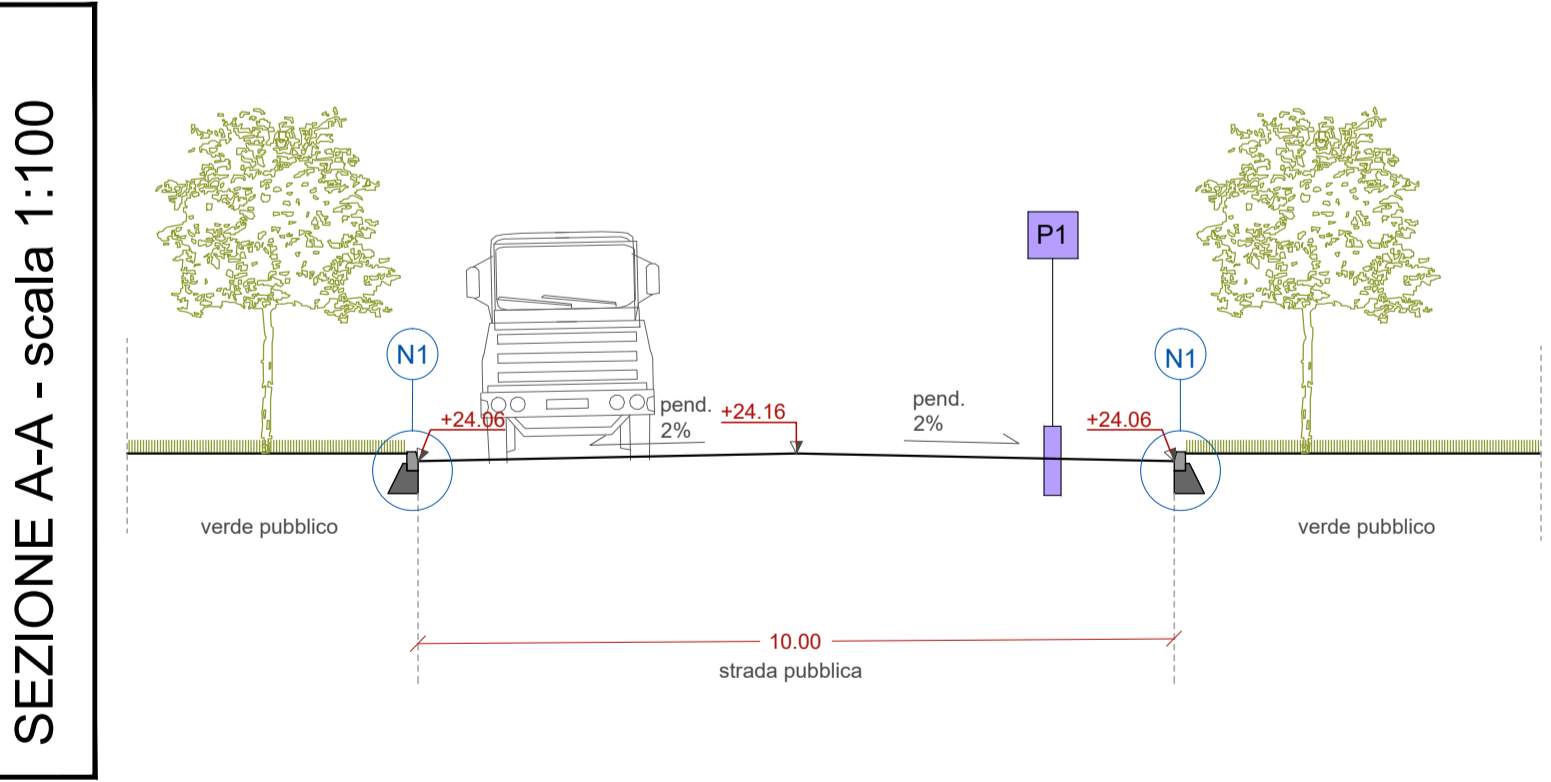
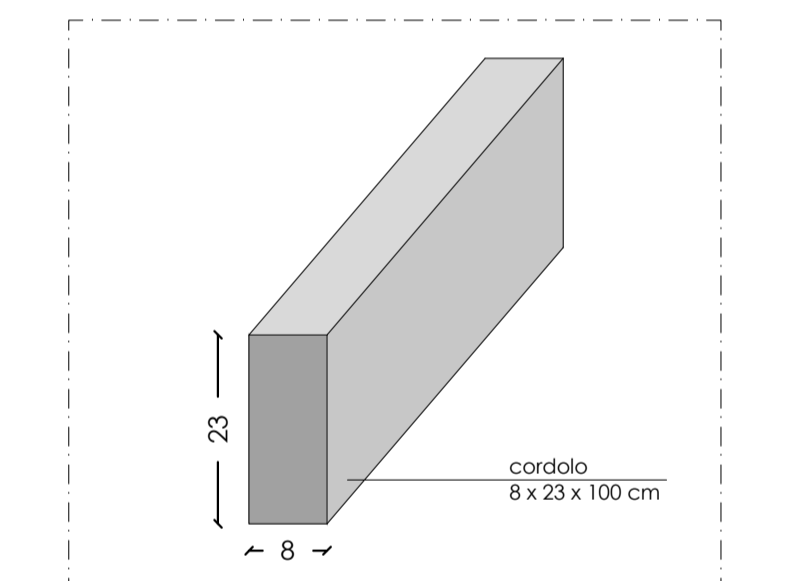

pianta F-F - scala 1:200

